

# **Eminere<sup>®</sup> Inground 2 II Wireless DMX** **Eminere<sup>®</sup> Inground 4 II Wireless DMX**

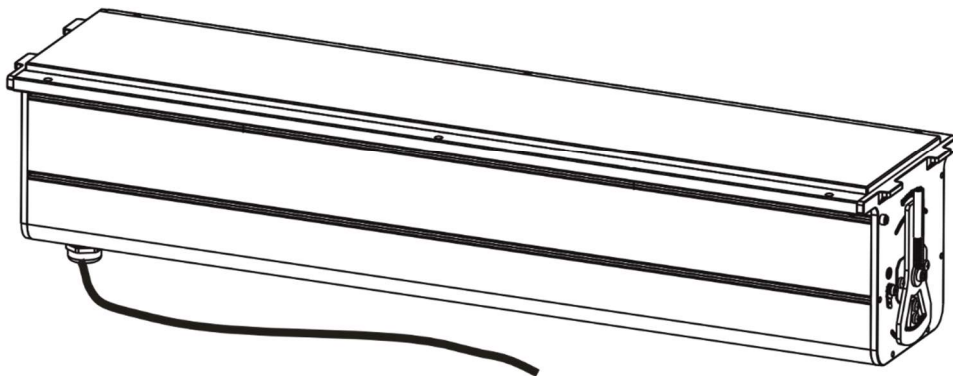

QR code for user manual



**USER MANUAL**

Version 1.0

## Table of contents

1. Safety instructions .....	3
2. Fixture exterior view .....	5
3. Installation .....	5
3.1 Mounting the Eminere Inground .....	5
3.2 Example of Control panel in RDM manager .....	14
4. Technical specifications .....	16
5. Cleaning and maintenance .....	19
5.1 Disposing of the product .....	19
6. ChangeLog .....	19

**FOR YOUR OWN SAFETY, PLEASE READ THIS USER MANUAL CAREFULLY  
BEFORE POWERING OR INSTALLING YOUR Eminere Inground II !  
Save it for future reference.**

This device has left our premises in absolutely perfect condition. In order to maintain this condition and to ensure safe operation, it is absolutely necessary for the user to follow the safety instructions and warnings written in this manual.

The manufacturer will not accept liability for any resulting damages caused by the non-observance of this manual or any unauthorized modification to the device.

Unauthorized modification will void warranty.

## 1. Safety instructions

**DANGEROUS VOLTAGE CONSTITUTING A RISK OF ELECTRIC SHOCK IS PRESENT WITHIN THIS UNIT!**

Always disconnect the fixture from AC power before cleaning, servicing or installing.

Make sure the supply/data cable cord is not damaged by sharp edges.

Do not install the fixture near an open flame.

Refer servicing to qualified service personnel.

**This fixture falls under protection class I. Therefore this fixture has to be connected to a mains socket outlet with a protective earthing connection.**

Do not connect this fixture to a dimmer pack.

***LED light emission. Risk of eye injury. Do not look into the beam from a short distance without suitable protective eyewear. Do not look at LEDs with magnifiers or similar optical instruments that may concentrate the light output.***

Avoid brute force when installing or operating the fixture.

The fixture was designed for outdoor use. This fixture must not be used for underwater installation.

When choosing the installation spot, please make sure that the fixture is not exposed to extreme heat or dust.

Avoid using the unit in locations subject to possible impacts.

The fixture body never must be covered with cloth or other materials when the fixture is under operation.

Only operate the fixture after having checked that the housing is firmly closed and all screws are tightly fastened.

The fixture becomes hot during operation. Allow the fixture to cool approximately 30 minutes prior to servicing or maintenance.

Dismantling of the unit in case of its repair must not be carried out in rain.

Please consider that unauthorized modifications on the fixture are forbidden due to safety reasons!

Operate the fixture only after having familiarized yourself with its functions. Do not permit operation by persons not qualified to operate the fixture.

If this device will be operated in any way different to the one described in this manual, the product may suffer damages and the warranty becomes void. Furthermore, any other operation may lead to dangers like short-circuit, burns, electric shock etc.

The product (covers and cables) must not be exposed to a high frequency electromagnetic field higher than 3V/m.

Immunity of the equipment is designed according to the standard EN 55035 Electromagnetic compatibility of multimedia equipment - Immunity requirements

Emission of the equipment complies with the standard EN55032 Electromagnetic compatibility of multimedia equipment – Emission Requirements according to class B.

This device complies with part 15 of the FCC Rules. Operation is subject to the following two conditions: (1) This device may not cause harmful interference, and (2) this device must accept any interference received, including interference that may cause undesired operation.

Changes or modifications not expressly approved by the party responsible for compliance could void the user's authority to operate the equipment.

The [Device] wireless operation is safe and complies to RF Exposure requirements.

This equipment has been tested and found to comply with the limits for a Class B digital device, pursuant to part 15 of the FCC Rules. These limits are designed to provide reasonable protection against harmful interference in a residential installation. This equipment generates, uses and can radiate radio frequency energy and, if not installed and used in accordance with the instructions, may cause harmful interference to radio communications. However, there is no guarantee that interference will not occur in a particular installation. If this equipment does cause harmful interference to radio or television reception, which can be determined by turning the equipment off and on, the user is encouraged to try to correct the interference by one or more of the following measures:

- Reorient or relocate the receiving antenna.
- Increase the separation between the equipment and receiver.
- Connect the equipment into an outlet on a circuit different from that to which the receiver is connected.
- Consult the dealer or an experienced radio/TV technician for help.

## 2. Fixture exterior view

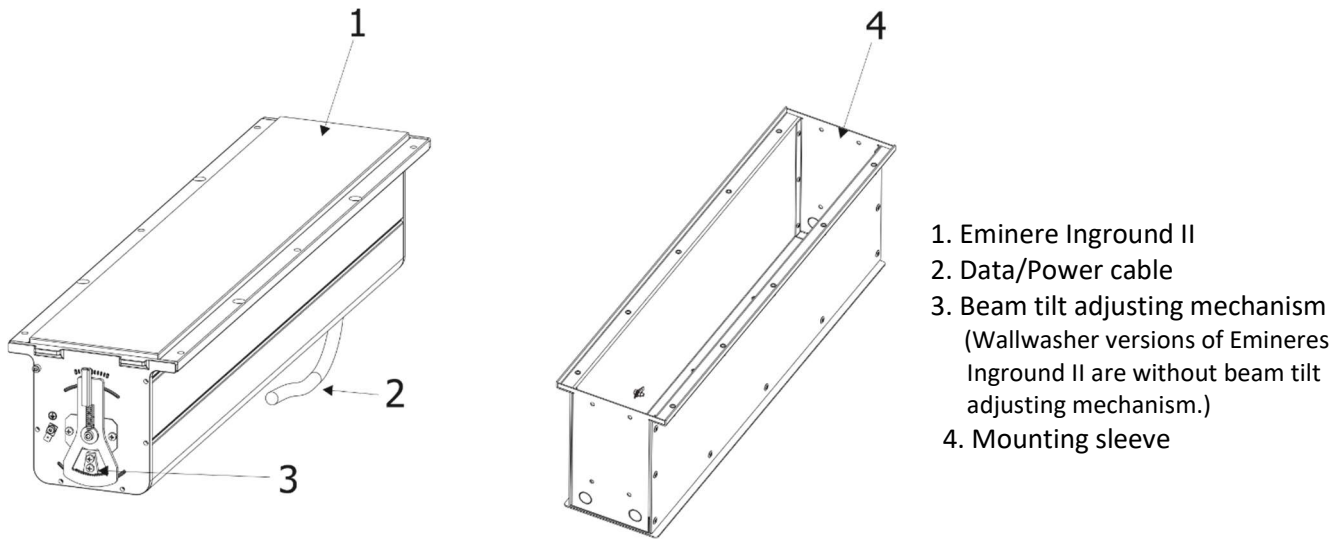

## 3. Installation

*The unit must be installed by a qualified electrician in accordance with all national and local electrical and construction codes and regulations.*

*This device falls under class one and must be grounded!*

*With respect to the purpose of using the unit, the residual current circuit breaker is highly recommended.*

### 3.1 Mounting the Eminere Inground

#### **Warning!**

*If the Eminere Inground will be exposed to max. allowed static load, the subsoil under the installation sleeve has to withstand load of: 45kN (standard covering glass)  
23kN (antiskid covering glass).*

#### Example of installation of the Eminere Inground 2 II

1. Prepare an adequate hole with a good drainage leaving at least 300 mm of gravel on the bottom of the hole for inserting the mounting sleeve (1) into the prepared hole. There must not stay water in the mounting sleeve.

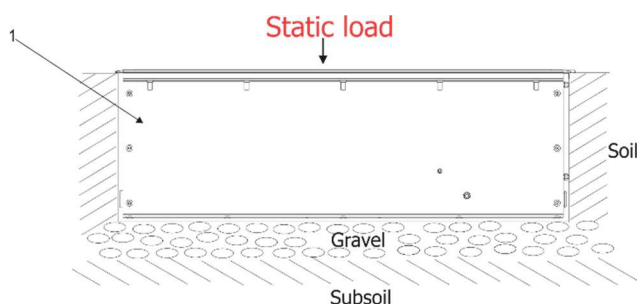

## Eminere Inground II Wireless DMX

2. Remove the temporary cover (4) from the mounting sleeve (1) by unscrewing the six cap head allen bolts (5).
3. In sleeve that Emineres Inground II will be installed side by side, the four holes (10) on the side of the mounting sleeve serve for attaching next mounting sleeve by means of the four screws M5x10 (2) (with washer and nuts). Two rubber grommets (3) insert to the holes (9) on the side of the mounting sleeve which you will use for passing cables to next mounting sleeve (the rubber grommets insert to holes after screwing both mounting sleeves together).
4. The connection points (7) serve for grounding the Eminere Inground II and the mounting sleeves each other.

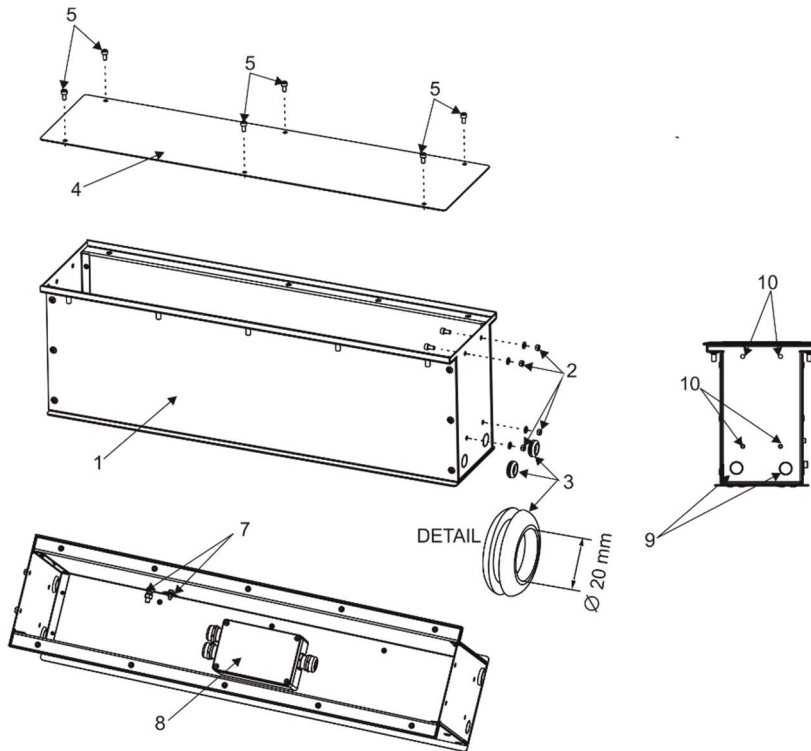

5. Connect the Eminere Inground II (13) and all needed cables to the junction box (8).

Note: the cable (11) of the Eminere Inground II is 2 m long, we recommend to shorten the cable on 1 m.

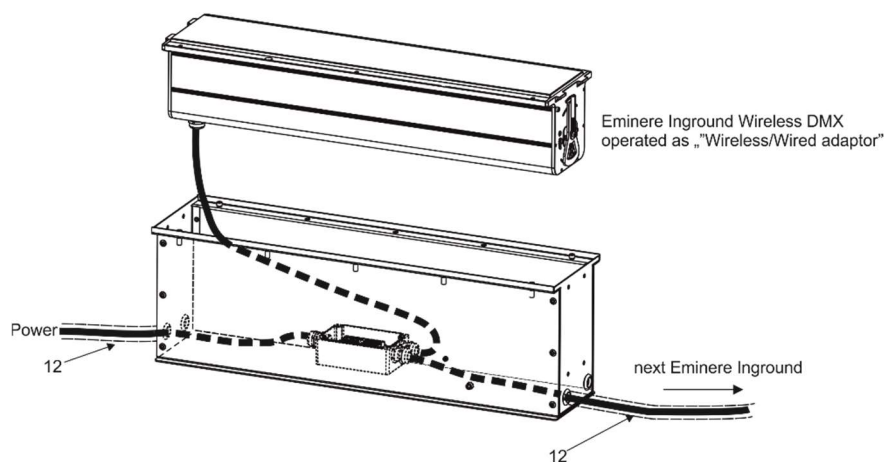
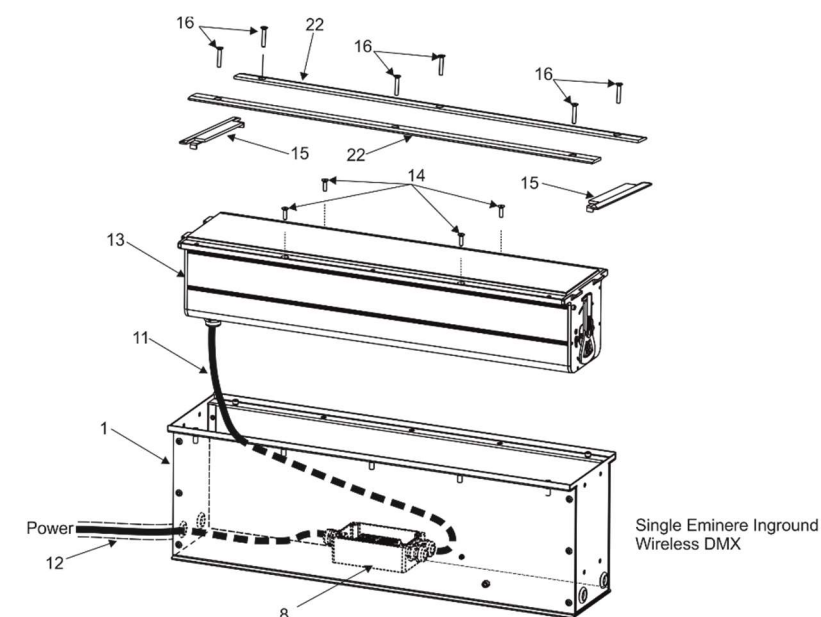

The supply cable to the mounting sleeve and power/data cable from the mounting sleeve must be placed in a protective tube (12).

6. After connecting cables to the junction box (8), screw the Eminere Inground II (13) to the mounting sleeve (1) by means of the four countersunk-head bolts M5x25 (14). The screws (14) must be tightened smoothly with torque of 4Nm. Do not use impact wrench. Check the correct orientation of the Eminere Inground II for beam tilting- direction of beam tilting is marked by a sticker on the side of the Eminere Inground II.
7. Screw the cover plates (15), (22) on the mounting sleeve (1) by means of the six countersunk-head bolts M5x30 (16). The crews (16) must be tightened smoothly with torque of 4Nm. Do not use impact wrench.

### Junction box (not sold with the device)

The Eminere Inground II is equipped with auto-switching power supply that automatically adjusts to any 50-60Hz AC power source from 120-277 Volts.

***Do not connect (disconnect) Emineres Inground II each other when they are under voltage!***

1. Unscrew the four screws M4x20 (17) on the cover of the junction box and remove this cover (18) with gasket (19) to get access to the connection block (20).

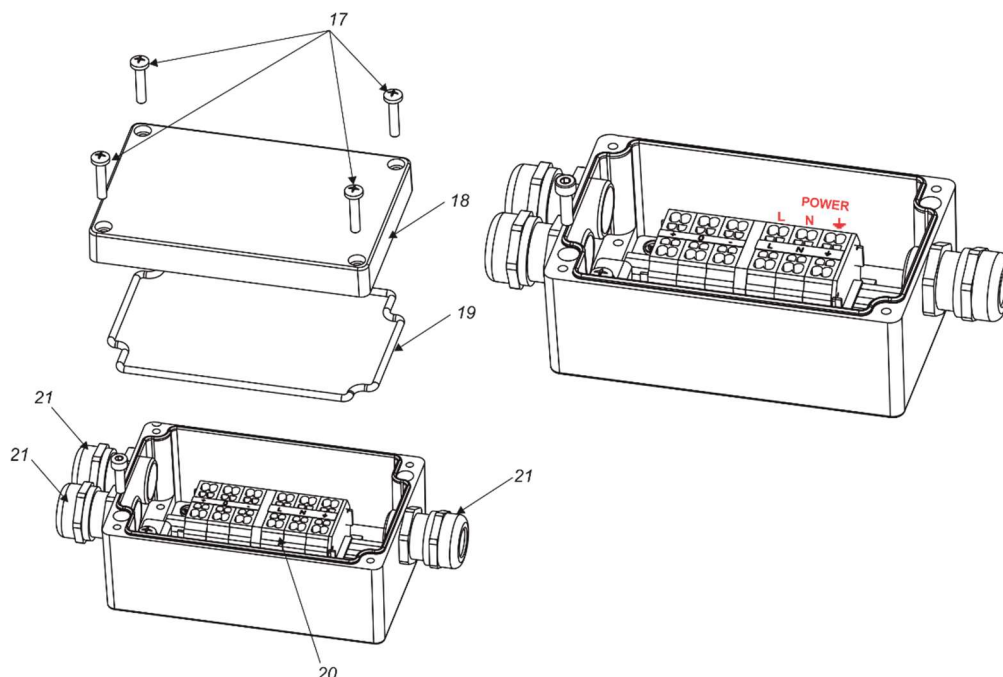

2. Connect cables to the connection block (20).

Wiring of the Eminere cable (CE version):

Core	Power Connection
Brown	L
Blue	N
Yellow/Green	⊕ (earth)

Wiring of the Eminere cable (US version):

Core	Power Connection
Black	L
White	N
Green	⊕ (earth)

The three cable glands M20 (21) are intended for cable of diameter of 6-12mm.



### Cable gland M20:

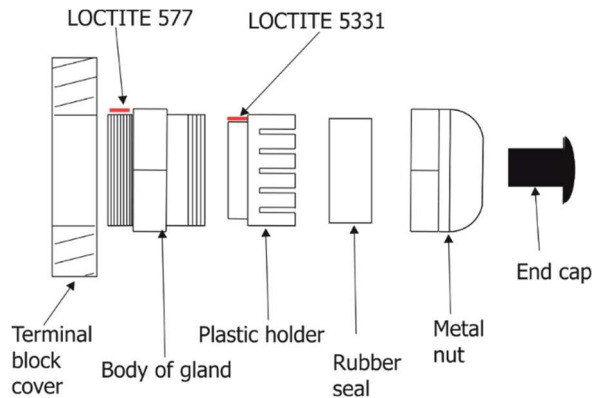

We recommend to apply an adequate layer of the paste LOCTITE 5331 on the plastic holder of the cable gland before inserting it into the body of the gland and an adequate layer of the paste LOCTITE 577 on the thread of the gland body in case that you need to unscrew and remove the cable gland from the housing of the junction box and and screw it back to the housing.

Remove end caps from cable glands before passing cables into the junction box.

Fully tighten cable gland nuts and check that cables are properly fastened in the cable glands.

Note: every cable gland has to be covered with the end cap if this cable gland is not used for cable passing.

3. After checking all connections, fill the junction box with synthetic resin. Make sure that the End cap is inserted in unused cable gland and the earth wire for cover is pulled out of the junction box before filling it. At filling of the junction box proceed according instructions stated on the bag of the resin. The connection box (20) has to be fully poured in the resin.

Prepared junction box and resin bag.

(Junction box and bag of resin are optional accessories).



## Eminere Inground II Wireless DMX

Junction box filled with resin.

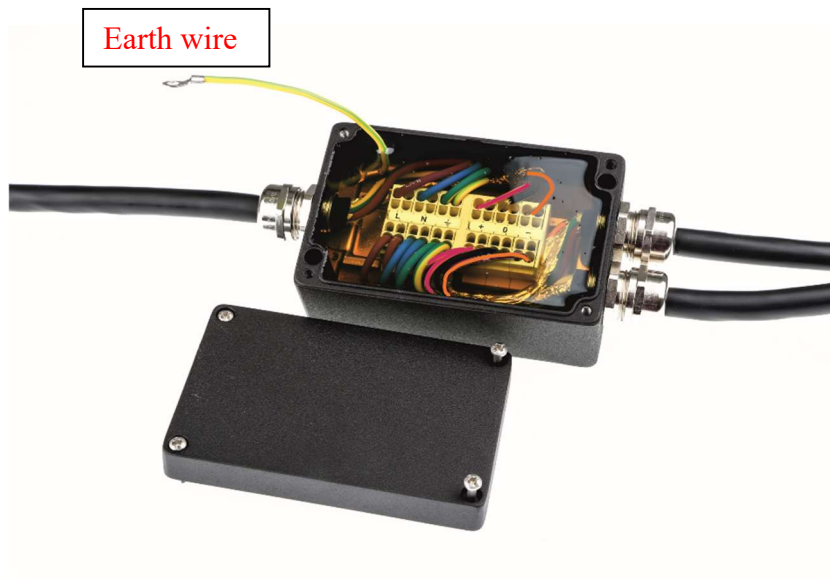

4. Screw the cover (18) with gasket (19) to the junction box by means of the four screws (17) and check they are fully tighten.
8. If you install two or more Emineres Inground II side by side, you have to screw three types of the cover plates: end (15), middle (23) and continuous (22). Insert the cover plate middle (23) between two mounting sleeves and screw rest of cover plates to the Emineres Inground II by means of the countersunk allen head bolts M5x25 (16).

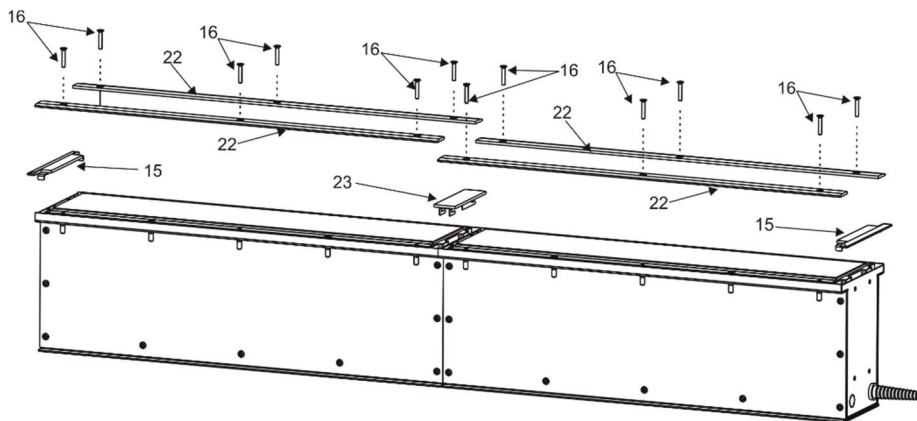

Cover plates overview:

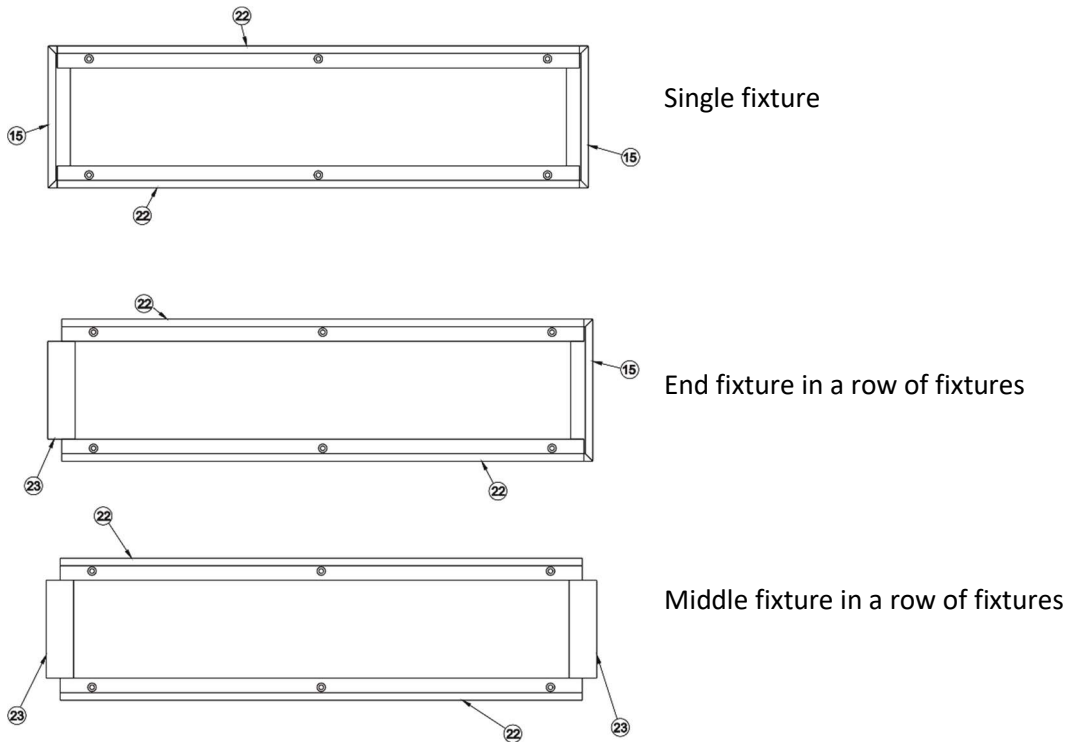

(15)-Cover plate end (optional )

(22)-Cover plate continuous (optional)

(23)-Cover plate middle (one piece is a standard part of fixture)

9. Tilt adjustment. The Eminere Inground II can be tilted 0°-15° after installing it in the mounting sleeve. Push and hold the small tube (24) to release the lock of the Eminere Inground II and tilt the device to desired position. Release the small tube (24) to lock the new position of the Eminere Inground II.
- Note.** The wallwasher versions of all Emineres Inground II do not have the beam tilt adjusting mechanism.

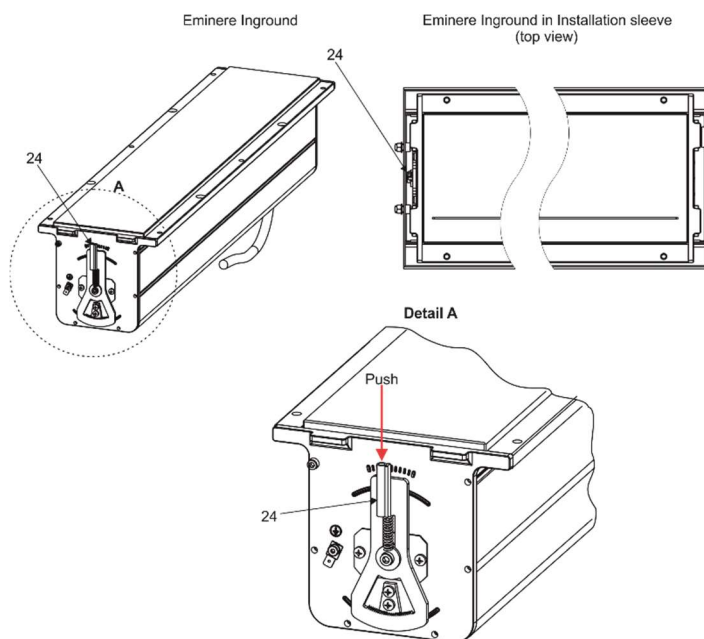

**DMX addressing of connected Emineres Inground II has to be done manually by means of the Robe Universal Interface WTX and the software RDM Manager.**

Direct visibility between a transmitter and the Eminere Inground II Wireless DMX must be ensured without no obstacles (bildings, trees, cars....).

The angle between the ground with the Eminere Inground II Wireless DMX and the transmitter's antenna has to be more than 10°. Distance between a DMX transmitter and the Eminere Inground II Wireless DMX depends on transmission range of used DMX transmitter, surrounds etc (we recommend to test behaviour of DMX transmitter with the Eminere Inground II Wireless DMX before installation).

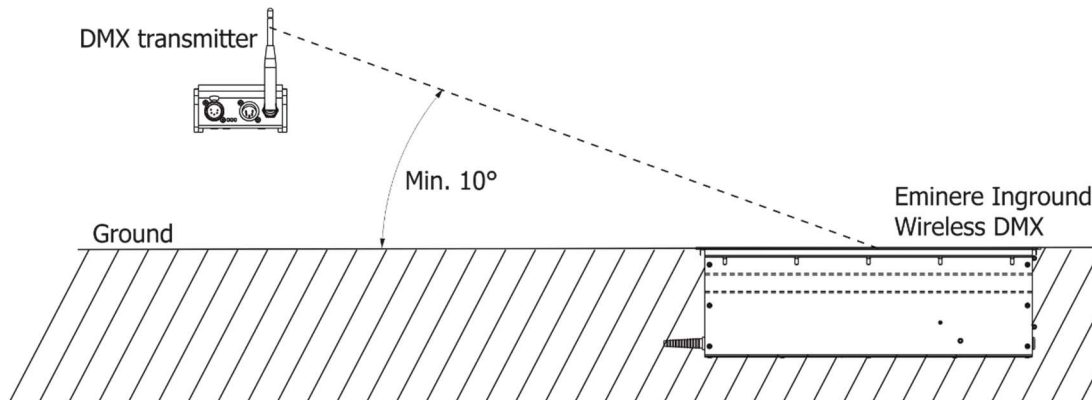

### Examples of connection

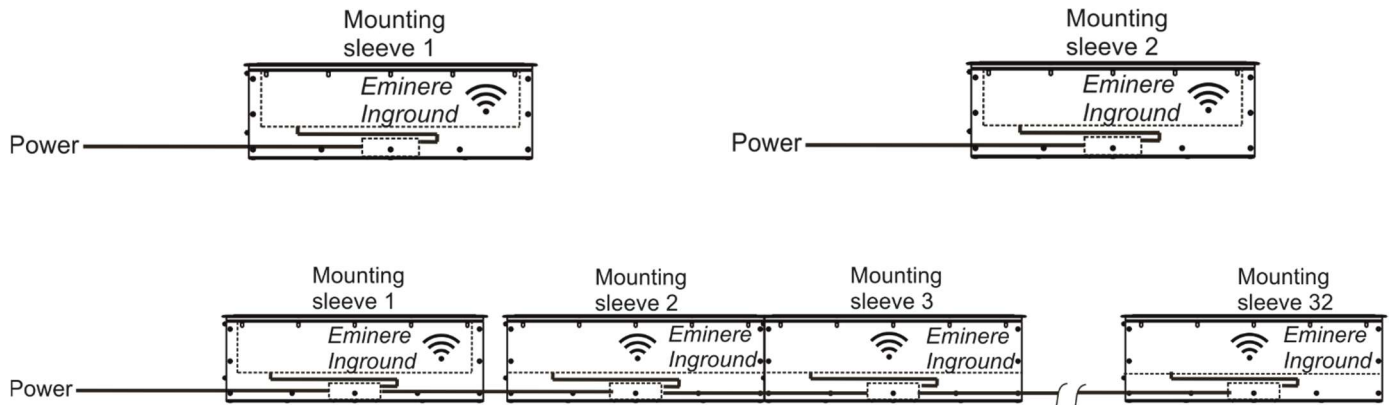

The Eminere Inground II can be only linked to a transmitter by running the link procedure at DMX transmitter .

The Eminere Inground II can be unlinked from the transmitter by running the unlink procedure at DMX transmitter or by switching off/on the Eminere Inground II three times while the transmitter is switched off.

During off/on unlink procedure, the Eminere Inground II has to be switched on for 5 seconds in steps 1-3:

Step 1: Eminere Off, Eminere On (5s)

Step 2: Eminere Off,Eminere On(5s)

Step 3: Eminere Off, Eminere On (5s)

Step 4: Eminere Off, Eminere On

Successful unlink is signaled by flashing LEDs at fourth switching the Eminere Inground II Off and On. If the LEDs flashing will not appear, probably the 5 seconds period has not been kept and you have to repeat the Off/On procedure to unlink the fixture from the DMX transmitter .

**DMX addressing of connected Emineres Inground II has to be done manually by means of the Robe Universal Interface WTX and the software RDM Manager.**

Theoretically up to 32 Emineres Inground II can be connected in DMX chain, but number of connected Emineres Inground II in series also depends on their cable length, power voltage and type of Emineres Inground II.

The tables below state max. theoretical number of Emineres connected in series without Booster boxes.

Eminere Inground 2 II Wireles DMX	Voltage			
Cable length *	120V	190V	230V	277V
10 m	32	32	32	32
20 m	32	32	32	32
30 m	28	32	32	32
50 m	17	32	32	32
70 m	12	31	32	32
100 m	9	21	32	32

Eminere Inground 4 II Wireles DMX	Voltage			
Cable length *	120V	190V	230V	277V
10 m	21	32	32	32
20 m	21	32	32	32
30 m	15	32	32	32
50 m	9	22	32	32
70 m	6	16	23	32
100 m	4	11	16	23

\* Cable length is a total cable length among connected Emineres Inground II including power cable of the first Eminere Inground II.

Example of connection:

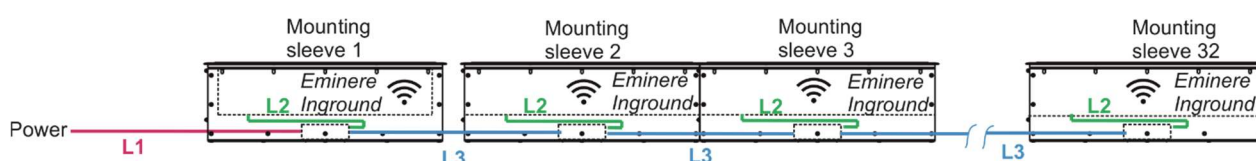

Total cable length=  $L1 + \sum L2 + \sum L3$ .

**Max. total cable length must not exceed 100m.**

### 3.2 Example of Control panel in RDM manager

The software RDM manager is available on the ROBE website (<https://www.robe.cz/support>), product RUNIT WTX.

Control panel

Device: 52:53-01:2e:00:7f

Product information

RDM protocol version: 0x0100  
Device model ID: 0x010a  
Product category: 0x0102  
Software version: 18  
Subdevice count: 0  
Sensor count: 2  
Manufacturer label: ROBE lighting s.r.o.  
Device model description: Eminere  
Device label: EminereSC

DMX512 setup

DMX512 footprint: 12  
Current personality: DMX Preset 03-12  
Personalities count: 23  
DMX address: 1

Power/Lamp setup

Device hours: 0

Configuration

Factory defaults: Set

Control

Identify device: off

Display settings

Manufacturer PIDs

Wireless Unlink 1-unlink: (hex)  
LED calibration 4byte HEX! (RGBW/RGBA): ff 88 00 08 (hex)  
Insect friendly light (0 = off, 1 = on): 00 (hex)  
Pixel swap (0-dis 1-act): 00 (hex)  
Terminator active (0-dis 1-en): 00 (hex)

Green arrow  saves changes made in the Control panel to the Eminere Inground II.

## Manufacturer PIDs

Wireless unlink - the item allows you to unlink the Eminere Inground II from a DMX transmitter.

LED calibration 4byte HEX! (RGBW/RGBA) - the item shows 4 bytes of calibration values for calibrated white colours of RGBW(RGBA) Eminere Inground II.

E.g.

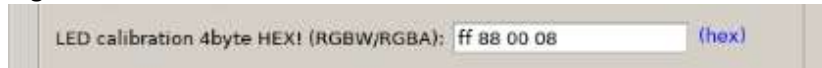

CTC channel has to be set to some calibrated white colour (21 DMX-1800K, 66 DMX-2700K, 91 DMX-3200K, 141 DMX-4200K, 211 DMX-5600K, 255 DMX-6500K) otherwise the item shows values "ff ff ff ff" (and calibration values cannot be saved to the Eminere Inground II).

### **Warning!**

***Changing and saving values in this item will effect calibrated white colour(s) of the Eminere Inground II .***

Insect friendly light - the item effects RGBA Eminere Inground II only. If the item is on, blue colour is not used in calibrated white colours. This modification of white lights results in a smaller attraction of white light for insects (mosquitos, moths..). The function is also available from DMX chart (channel Special Function, range 7-10 DMX).

Pixel Swap – the item allows you to swap the pixel order (for Eminere Inground 2/4 II only).

Terminator active - the item allows you to terminate line of Emineres Inground II at last Eminere Eminere Inground II.

## 4. Technical specifications

### Power supply

- Electronic auto-ranging
- Input voltage: 120 - 277V AC, 50-60 Hz
- Power consumption:
  - Eminere Inground 2 II: 50W
  - Eminere Inground 4 II: 90W
- Inrush current:
  - Eminere Inground 2 II: <70A/250μs
  - Eminere Inground 4 II: <100A/200μs

### Optic

- Light source:
  - Eminere Inground 2 II: 24 x high power LEDs
  - Eminere Inground 4 II: 48 x high power LEDs
- Colour variants: RGBW (W - 6500 K), RGBA, WW (W - 3000 K)
- Beam angles: Symetrical: 9°, 15°, 30°, 50°, 65°, 100°
  - Bi-symetrical: 10° x 30°, 30° x 10°, 10° x 60°, 60° x 10°, 35° x 70°, 70° x 35°, 15° x 90°, 90° x 15°
  - Anti- Skid (symmetrical): 18°, 22°, 35°, 50°, 65°, 100°
  - Anti-Skid (Bi-symmetrical): 20° x 35°, 20° x 65°, 20° x 90°, 40° x 70°
  - Wallwasher, Wide Wallwasher
- Projected Lumen Maintenance: L90B10 >90.000 hrs, Ta = 25°C / 77°F

### Interface Protocol

- USITT DMX512, RDM

### Wireless DMX/RDM module (type RW 001)

- Supported protocols: full RDM support, CRMX , W-DMXTM G2, G3,G4 and G4S
- Operational frequency range: 2402-2480 MHz
- Output power: 100 mW
- Receiver sensitivity (0.1% BER): -93 dBm
- Contains FCC ID: 2A6PL-DMXRDMRW001
- Contains IC: 29573-DMXRDMRW001

### Mounting method

- Inground mount

### Adjustability

- 0°- 15° after instalation

### Housing

- High pressure extruded aluminium body
- End caps - Die-Cast Aluminium
- Welded instalation sleeve for pre-instalation
- Tempered glass

### Cooling system

- Convection

### Total heat dissipation

- Eminere Inground 2 II: 130 BTU/h (calculated)
- Eminere inground 4 II: 228 BTU/h (calculated)



**Protection factor**

- CE: IP 67
- US: Suitable for wet location

**Impact rating**

- CE: IK09

**Max. static load**

- Standard tempered glass: 45kN
- Antiskid tempered glass: 23kN

**Operating ambient temperature range**

- -20°C /+40°C (-4°F /+104°F)

**Operating temperature**

- +80 °C @ Ambient +40 °C (+176 °F @ Ambient +104 °F)

**Connection**

- Junction box

**Weight**

- Eminere Inground 2 II: 18.5 kg / 40.8 lbs (9 kg / 19.8 lbs Eminere Inground 2 II Fixture, 9.5 kg / 20.9 lbs install. Sleeve)
- Eminere Inground 4 II: 36.2 kg / 79.8 lbs (17.5 kg / 38.6 lbs Eminere Inground 4 II Fixture, 18.7 kg / 41.1 lbs Install. Sleeve)

**Dimensions (All dimensions in mm [inch])**

- Eminere Inground 2 II/Eminere Inground 4 II

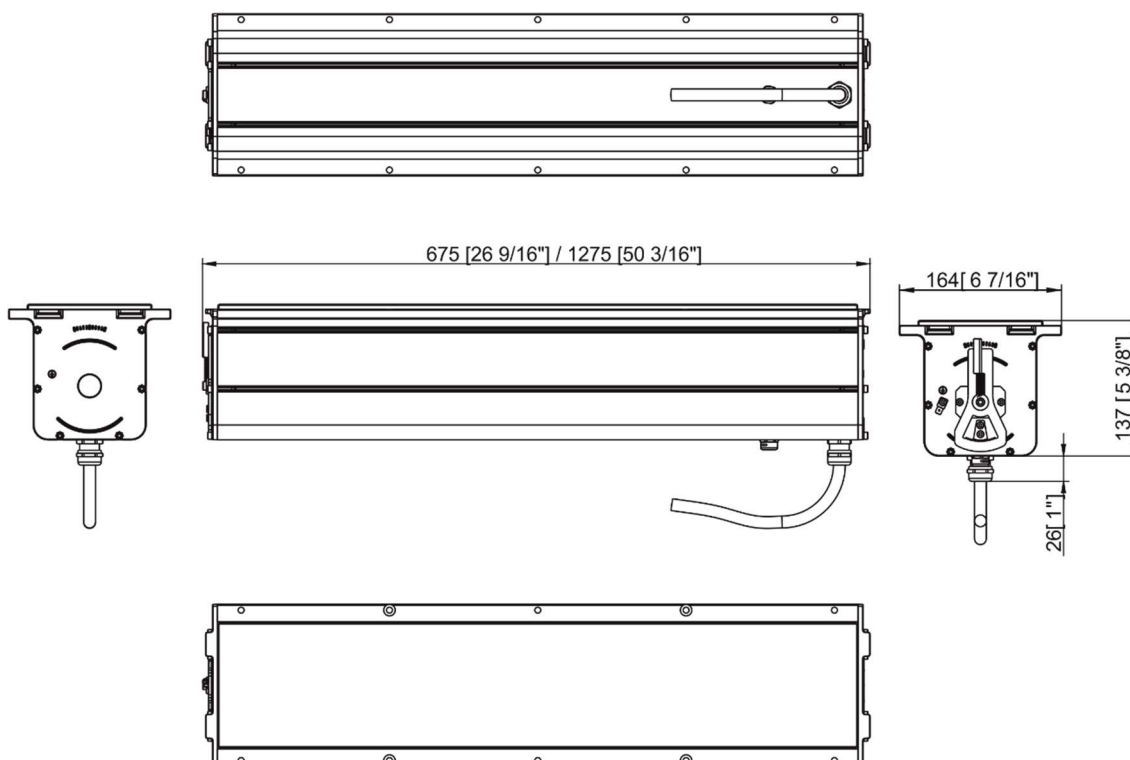

## Eminere Inground II Wireless DMX

### Dimensions with mounting sleeve (All dimensions in mm [inch])

- Eminere Inground 2 II/Eminere Inground 4 II

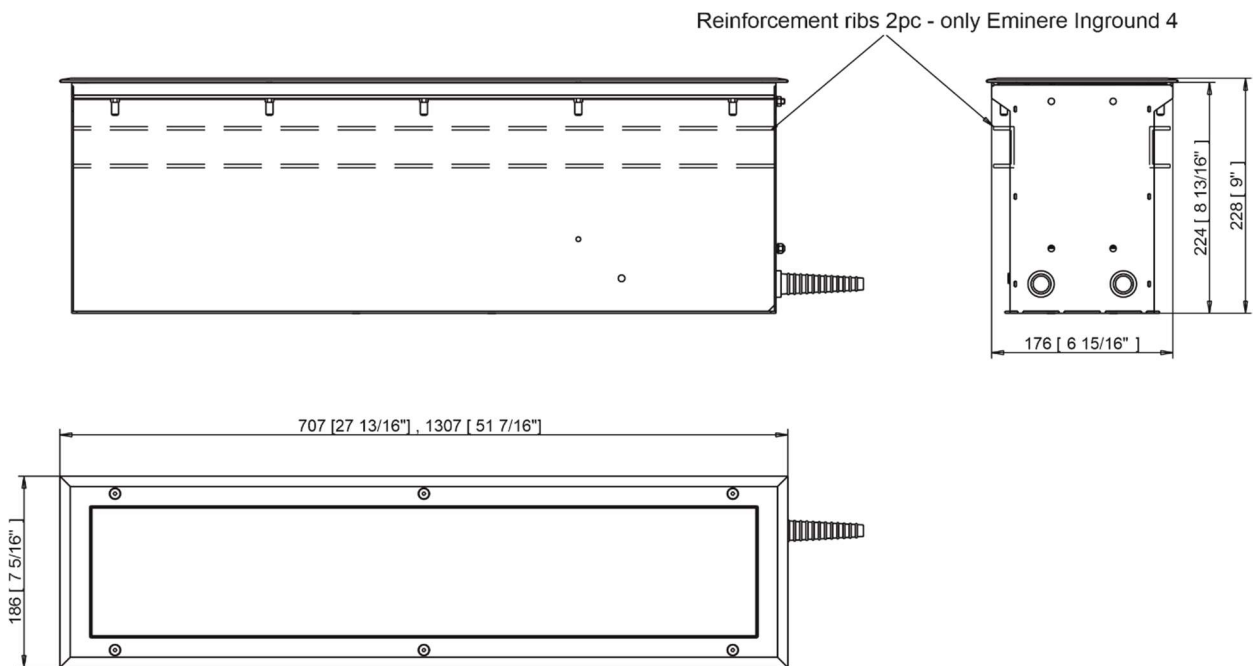

### Included items

- 1 x Eminere Inground II
- 1 x mounting sleeve
- 1 x User manual

### Optional accessories

- P/N 10981201 Eminere Inground 1 II Mounting Sleeve
- P/N 10980712 Eminere Inground 1 cover plate continuous (set)
- P/N 10981202 Eminere Inground 2 II Mounting Sleeve
- P/N 10980508 Eminere Inground 2 cover plate continuous (set)
- P/N 10981203 Eminere Inground 4 II Mounting Sleeve
- P/N 10980526 Eminere Inground 4 cover plate continuous (set)
- P/N 10980509 Eminere Inground cover plate end (set)
- P/N 10981204 Eminere Inground 1 II Trim Standalone
- P/N 10981205 Eminere inground 2 II Trim Standalone
- P/N 13053138 Cable CE WCA
- P/N 13053139 Cable US WCA
- P/N 99016331 Junction box for Eminere Inground
- P/N 90031150 Bag of resin (for one junction box)

## 5. Cleaning and maintenance

***DANGER !***  
***Disconnect from the mains before starting any maintenance or cleaning work***

Rinse off loose dirt with low pressure water spray. Wash the housing with a soft brush or sponge and a mild, non-abrasive washing detergent. Rinse it.

Maintenance and service operations are only to be carried out by a qualified person.

Should you need any spare parts, please use ROBE OEM parts.

### 5.1 Disposing of the product

To preserve the environment please dispose or recycle this product at the end of its life according to the local regulations and codes.

## 6. ChangeLog

This section summarizes changes in the user manual.

Version of the manual	Date of issue	Description of changes

*Specifications are subject to change without notice.*

*May 23, 2025*

*Copyright © 2025 Robe Lighting - All rights reserved*

Made in CZECH REPUBLIC by ROBE LIGHTING s.r.o. Palackeho 416/20 CZ 75701 Valasske Mezirici

DMX protocol for: Eminere 1/2/3/4; Eminere Side 1/2/3/4; Eminere Inground 1/ 2/4; Eminere Inground 1/2/4 II; Eminere Remote 1/2/3/4; UVinere 2/4; UVinere Remote 1/2/4									
Version: 3.3 (23 modes in total), software version 3.0 and higher									
Mode/Channels in all								Mode 1: RGBW(A)-8bit, Mode 2: RGB 8-bit, Mode 3: full RGBW(A)	
1	2	3	4	5	6	7	8-10	Mode 4: White-full control, Mode 5: Reduced RGBW(A)	
4	3	12	3	6	8	15	Reserved	Mode 6- Reduced RGBW(A)+white control	
								Mode 7- full RGBW(A)+virtual colour wheel	
								RGBW(A) / RGB modes	
Mode/channels							DMX Value	Function	Type of control
1	2	3	4	5	6	7			
-	-	-	-	-	-	1	0	<b>Special functions</b> No function	step
								<i>To activate following functions , stop in DMX value for at least 3 sec.</i>	
							1-2	Save current DMX values to fixture as initial DMX values.	step
							3-4	Show saved initial DMX values	step
							5-6	Run factory demo sequences at switching fixture on (without DMX)	step
							7-8	Insect friendly light On (RGBA version only)	step
							9-10	Insect friendly light Off (RGBA version only)	step
							11-255	Reserved	
1	1	1	-	1	1	2	0-255	<b>Red</b> Red LEDs saturation control (0-100%)	proportional
-	-	2	-	-	-	3	0-255	<b>Red Fine</b> Red LEDs saturation control fine	proportional
2	2	3	-	2	2	4	0-255	<b>Green</b> Green LEDs saturation control (0-100%)	proportional
-	-	4	-	-	-	5	0-255	<b>Green Fine</b> Green LEDs saturation control fine	proportional
3	3	5	-	3	3	6	0-255	<b>Blue</b> Blue LEDs saturation control (0-100%)	proportional
-	-	6	-	-	-	7	0-255	<b>Blue Fine</b> Blue LEDs saturation control fine	proportional
4	-	7	-	4	4	8	0-255	<b>White (Amber)</b> White LEDs saturation control (0-100%)	proportional
-	-	8	-	-	-	9	0-255	<b>White (Amber) Fine</b> White LEDs saturation control fine	proportional
-	-	9	1	-	5	10	0	<b>Green correction</b> Uncorrected white	step
							1-127	Minus green --> uncorrected white	proportional
							128	Uncorrected white (128=default)	step
							129-255	Uncorrected white --> Plus green	proportional
-	-	10	2	-	6	11	0	<b>Colour temperature correction (CTC)</b> No function	step
							1-10	Tungsten dimming 2700 K	step
							11-20	Tungsten dimming 3200 K	step
							21-255	Colour temperature changing from 1800 K --> 6500 K (21-1800K, 66-2700K, 91-3200K,141-4200K, 211-5600K, 255-6500K)	proportional

# DMX protocol

Mode/channels							DMX Value	Function	Type of control
1	2	3	4	5	6	7			
-	-	-	-	-	-	12		<b>Virtual Colour Wheel</b>	
							0	No function	step
							1-2	White 1800 K	step
							3-4	White 2700 K	step
							5-6	White 3200 K	step
							7-8	White 4200 K	step
							9-10	White 5600 K	step
							11-12	White 6500 K	step
							13	Blue (Blue=full, Red+Green+White/Amber=0)	step
							14-23	Red=0, Green->up, Blue =full, White/Amber=0	proportional
							24	Cyan (Red=0, Green=full, Blue =full, White/Amber=0)	step
							25-34	Red=0, Green=full, Blue->down, White/Amber=0	proportional
							35	Green (Red=0, Green=full, Blue =0, White/Amber=0)	step
							36-45	Red->up, Green=full, Blue=0, White/Amber=0	proportional
							46	Yellow (Red=full, Green=full, Blue=0, White/Amber=0)	step
							47-56	Red=full, Green->down, Blue=0, White/Amber=0	proportional
							57	Red (Red=full, Green=0, Blue=0, White/Amber=0)	step
							58-67	Red=full, Green=0, Blue->up, White/Amber=0	proportional
							68	Magenta (Red=full, Green=0, Blue=full, White/Amber=0)	step
							69-78	Red -> down, Green=0, Blue=full, White/Amber=0	proportional
							79	Blue (Red=0, Green=0, Blue=full, White/Amber=0)	step
								<b>Transition effects</b>	
							80-87	Rainbow effect (with fade time) from slow-> fast	proportional
							88-95	Rainbow effect (without fade time) from slow-> fast	proportional
							96-103	Full dynamic white (1800K->6500K->1800K) (with fade time) from slow-> fast	proportional
							104-111	Full dynamic white (1800K->6500K->1800K) (without fade time) from slow-> fast	proportional
							112-119	Dynamic warm white (1800K-3000K-1800K) (with fade time) from slow-> fast	proportional
							120-127	Dynamic warm white (1800K-3000K-1800K) (without fade time) from slow-> fast	proportional
							128-135	Rainbow effect + full dynamic white (with fade time) from slow-> fast	proportional
							136-143	Rainbow effect + full dynamic white (without fade time) from slow-> fast	proportional
							144-151	Blue/Green effect (with fade time) from slow-> fast	proportional
							152-159	Blue/Green effect (without fade time) from slow-> fast	proportional
							160-167	Red/Blue effect (with fade time) from slow-> fast	proportional
							168-175	Red/Blue effect (without fade time) from slow-> fast	proportional
							176-183	Green/Red effect (with fade time) from slow-> fast	proportional
							184-191	Green/Red effect (without fade time) from slow-> fast	proportional
							192-199	Blue/4000K effect (with fade time) from slow-> fast	proportional
							200-207	Blue/4000K effect (without fade time) from slow-> fast	proportional
							208-215	Green/4000K effect (with fade time) from slow-> fast	proportional
							216-223	Green/4000K effect (without fade time) from slow-> fast	proportional
							224-231	Red/4000K effect (with fade time) from slow-> fast	proportional
							232-239	Red/4000K effect (without fade time) from slow-> fast	proportional
							240-255	Reserved	
						13		<b>Shutter/Strobe</b>	

# DMX protocol

Mode/channels							DMX Value	Function	Type of control
1	2	3	4	5	6	7			
							0-31	Shutter closed	step
							32-63	Shutter open	step
							64-95	Strobe-effect from slow to fast	proportional
							96-127	Shutter open	step
							128-143	Opening pulse in sequences from slow to fast	proportional
							144-159	Closing pulse in sequences from fast to slow	proportional
							160-191	Shutter open	step
							192-223	Random strobe-effect from slow to fast	proportional
							224-255	Shutter open	step
-	-	11	3	5	7	14		<b>Dimmer</b>	
							0-255	Light intensity coarse (0-100%)	proportional
-	-	12	-	6	8	15		<b>Dimmer Fine</b>	
							0-255	Light intensity fine	proportional
Copyright © 2022-2024 Robe Lighting s.r.o. - All rights reserved									
All Specifications subject to change without notice									

DMX protocol for: Eminere 1/2/3/4; Eminere Side 1/2/3/4; Eminere Inground 1/2/4; Eminere Inground 1/2/4 II; Eminere Remote 1/2/3/4; UVinere 2/4; UVinere Remote 1/2/4					
Version: 3.3 (23 modes in total)					
Mode/Channels in all				Mode 11: White selection, Mode 12: WW + CW	
11	12	13	14-16	Mode 13: Only dimmer	
3	4	2	Reserved	Mode 13 is suitable for UVinere and UVinere Remote	
				TW and PW modes	
Mode/channels			DMX Value	Function	Type of control
11	12	13			
1	-	-		White colour selection	
			0 - 255	White from 2700 K - 6500 K	proportional
-	1	-		Warm White	
			0 - 255	Warm White LEDs saturation control (0-100%)	proportional
-	2	-		Cool White	
			0 - 255	Cool White LEDs saturation control (0-100%)	proportional
2	3	1		Dimmer	
			0 - 255	Light intensity coarse (0 - 100%)	proportional
3	4	2		Dimmer Fine	
			0 - 255	Light intensity fine	proportional
Copyright © 2022-2024 Robe Lighting s.r.o. - All rights reserved					
All Specifications subject to change without notice					

**DMX protocol for: Eminere 1/2/3/4; Eminere Side 1/2/3/4;  
Eminere Inground 1/2/4; Eminere Inground 1/2/4 II; Eminere Remote 1/2/3/4;**

Version: 3.3 (23 modes in total)

Mode/Channels in all					Mode 17: RGBW(A) pixels, Mode 18: RGB pixels, Mode 19: TW pixels, Mode 20: PW dimmer pixels	
17	18	19	20	21-23		
16	12	8	8	Reserved		
					Pixel modes	
Mode/channels				DMX Value	Function	Type of control
17	18	19	20			
1	1	-	-	0 - 255	<b>Red 1 -Eminere 1/2/3/4</b> Red LEDs saturation control (0-100%)	proportional
2	2	-	-	0 - 255	<b>Green 1-Eminere 1/2/3/4</b> Green LEDs saturation control (0-100%)	proportional
3	3	-	-	0 - 255	<b>Blue 1-Eminere 1/2/3/4</b> Blue LEDs saturation control (0-100%)	proportional
4	-	-	-	0 - 255	<b>White (Amber) 1-Eminere 1/2/3/4</b> White LEDs saturation control (0-100%)	proportional
5	4	-	-	0 - 255	<b>Red 2 -Eminere 2/3/4</b> Red LEDs saturation control (0-100%)	proportional
6	5	-	-	0 - 255	<b>Green 2-Eminere 2/3/4</b> Green LEDs saturation control (0-100%)	proportional
7	6	-	-	0 - 255	<b>Blue 2-Eminere 2/3/4</b> Red LEDs saturation control (0-100%)	proportional
8	-	-	-	0 - 255	<b>White (Amber) 2-Eminere 2/3/4</b> White LEDs saturation control (0-100%)	proportional
9	7	-	-	0 - 255	<b>Red 3-Eminere 3/4</b> Red LEDs saturation control (0-100%)	proportional
10	8	-	-	0 - 255	<b>Green 3-Eminere 3/4</b> Green LEDs saturation control (0-100%)	proportional
11	9	-	-	0 - 255	<b>Blue 3-Eminere 3/4</b> Blue LEDs saturation control (0-100%)	proportional
12	-	-	-	0 - 255	<b>White (Amber) 3-Eminere 3/4</b> White LEDs saturation control (0-100%)	proportional
13	10	-	-	0 - 255	<b>Red 4-Eminere 4</b> Red LEDs saturation control (0-100%)	proportional
14	11	-	-	0 - 255	<b>Green 4-Eminere 4</b> Green LEDs saturation control (0-100%)	proportional
15	12	-	-	0 - 255	<b>Blue 4-Eminere 4</b> Blue LEDs saturation control (0-100%)	proportional
16	-	-	-	0 - 255	<b>White (Amber) 4 -Eminere 4</b> White LEDs saturation control (0-100%)	proportional
-	-	1	-		<b>Warm White 1 -Eminere 1/2/3/4</b> Warm White LEDs saturation control (0-100%)	proportional
-	-	2	-	0 - 255	<b>Cool White 1-Eminere 1/2/3/4</b> Cool White LEDs saturation control (0-100%)	proportional
-	-	3	-		<b>Warm White 2-Eminere 2/3/4</b>	



## DMX protocol

Mode/channels				DMX Value	Function	Type of control
17	18	19	20			
				0 - 255	Warm White LEDs saturation control (0-100%)	proportional
-	-	4	-	0 - 255	<b>Cool White 2-Eminere 2/3/4</b> Cool White LEDs saturation control (0-100%)	proportional
-	-	5	-	0 - 255	<b>Warm White 3-Eminere 3/4</b> Warm White LEDs saturation control (0-100%)	proportional
-	-	6	-	0 - 255	<b>Cool White 3-Eminere 3/4</b> Cool White LEDs saturation control (0-100%)	proportional
-	-	7	-	0 - 255	<b>Warm White 4 -Eminere 4</b> Warm White LEDs saturation control (0-100%)	proportional
-	-	8	-	0 - 255	<b>Cool White 4 -Eminere 4</b> Cool White LEDs saturation control (0-100%)	proportional
-	-	-	1	0 - 255	<b>Dimmer 1</b> Light intensity coarse (0 - 100%)	proportional
-	-	-	2	0 - 255	<b>Dimmer Fine 1</b> Light intensity fine	proportional
-	-	-	3	0 - 255	<b>Dimmer 2</b> Light intensity coarse (0 - 100%)	proportional
-	-	-	4	0 - 255	<b>Dimmer Fine 2</b> Light intensity fine	proportional
-	-	-	5	0 - 255	<b>Dimmer 3</b> Light intensity coarse (0 - 100%)	proportional
-	-	-	6	0 - 255	<b>Dimmer Fine 3</b> Light intensity fine	proportional
-	-	-	7	0 - 255	<b>Dimmer 4</b> Light intensity coarse (0 - 100%)	proportional
-	-	-	8	0 - 255	<b>Dimmer Fine 4</b> Light intensity fine	proportional
Copyright © 2022-2024 Robe Lighting s.r.o. - All rights reserved						
All Specifications subject to change without notice						