

LYRAE™ XS FIX MC

Difficult inground installations are made easier with the Lyrae XS Fix MC. High light output comes from powerful LEDs and it can be used with a variety of optics, from narrow to wide, in addition to a bi-symmetrical option. Additionally, Lyrae XS Fix MC can be equipped with anti-skid glass featuring the highest standards of certification for anti-slip usage having no impact on the fixture's outstanding colour mixing.



KEY FEATURES

Lumen output & Light source

Luminaire with one high-power LED provides light output with a high efficacy. Offering a choice of multiple LED colour variants, precise beam control with no light spill, and perfectly homogenised light output, it's an excellent solution for applications requiring high performance in a compact luminaire.

Design & Durability

Lightweight, compact, durable and stylish housing made of high-pressure die cast aluminium. IP68 and IK10 certification. Supported with a 5 year warranty.

Flexibility

An exceptionally compact luminaire available with a wide LED choices, and beam angle options, Lyrae XS offers the lighting designer a flexible solution for the most demanding applications.

COLOURS



CONTROL & PROTOCOLS

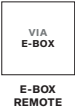

STANDARD & SPECIFICATION



TRIM FINISH OPTIONS



OPTIC OPTIONS

SYMMETRICAL

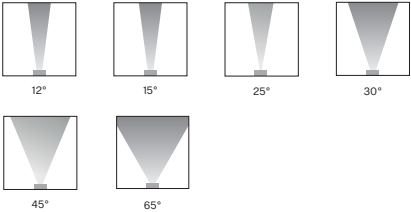

BI-SYMMETRICAL

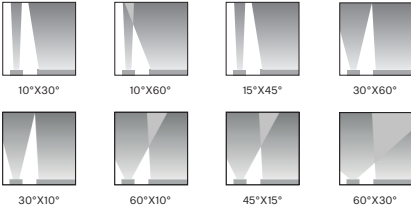

TRIM OPTIONS

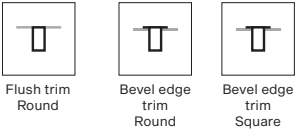

SPECIFICATION

ELECTRICAL	Typical Power Consumption	10 W		
	Input Voltage	48 V		
OPTICAL	Light Source	High Power Multi Chip LED		
	Colour Variants	RGBW (W - 6500 K)   RGBA		
	Beam Angle	Clear Glass	Symmetrical: 12°   15°   25°   30°   45°   65°	
			Bi-symmetrical: 10°x30°   30°x10°   10°x60°   60°x10°   15°x45°   45°x15°   30°x60°   60°x30°	
		Anti-Skid Glass	Symmetrical: 18°   22°   35°   50° (preliminary)	
			Bi-symmetrical: 20° x 35°   35° x 20°   20° x 65°   65° x 20°   20° x 50°   20° x 50°   35° x 65°   65° x 35° (preliminary)	
	Lumen Output Delivered	400 lm (@12° RGBW) (preliminary)		
Projected Lumen Maintenance	L90B10 >90.000 hrs, Ta = 25°C / 77°F			
CONTROL	Interface protocol	E-box Remote Range		
	E-Box Remote control protocol	USITT DMX512/RDM, ArtNet, MA Net, MA Net2, sACN, Kling-Net		
	Setting / addressing	E-box Remote range		
	Connectivity & Power Supply	E-Box Remote range		
PHYSICAL	Flange Diameter x Diameter x Height	Bevel Egde Trim: Ø 95 × Ø 105 × 134 mm (Ø 3.7 × Ø 4.1 × 5.3 in.)		
	Weight	0.56 kg   1.24 lbs		
	Housing	High Pressure Die-Cast Aluminium Body   Stainless Flange   Tempered Glass (Clear or Anti-Skid)		
	Trim Options	Bevel Edge Trim   Flush Trim		
	Trim Shape	Round   Square		
	Trim Finish Options	Stainless steel		
	Cables / Connectivity	1m cable, bare end (custom length on request)   Junction Box		
	Mounting Method	External Mounting Sleeve		
	Protection Factor	IP68 / Suitable For Wet Locations (8h @ 1m)		
	IK Rating	IK10		
	Static Load Resistance	35 kN (TBC)		
	Cooling System	Convection		
	Operating Ambient Temperature	-20 °C / +40 °C (-4 °F / +104 °F)		
CERTIFICATION	Listings	ETL / cETL, CE, RoHS, UKCA		
ACCESSORIES	Not Included Items			
	Lyrae XS Mounting Sleeve			
	Junction Box Remote (1x Output)			
	Junction Box Remote (4x Output)			
	Re-enterable Electrical Insulating Resin			
	Rock Guard			
DEMO SET	Lyrae XS Fix Demo Set	Includes: Lyrae fixture, Mounting Sleeve, Trim, Set of Optical Foils (Not suitable for permanent instalations. IP2X.)		

DIMENSIONS

with Round beveled Trim

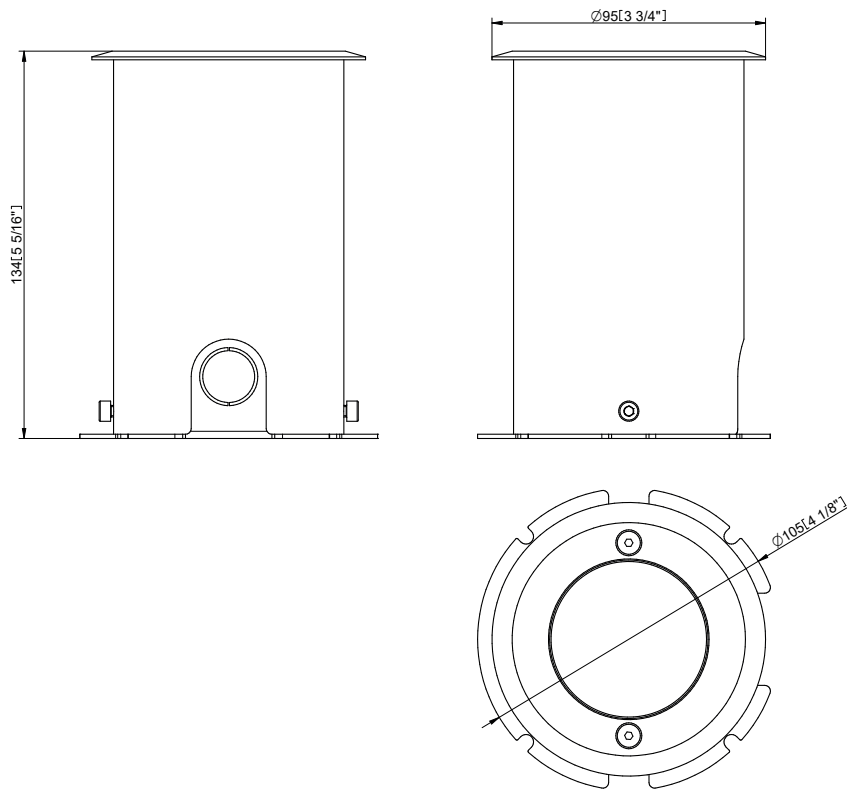

with Square beveled Trim

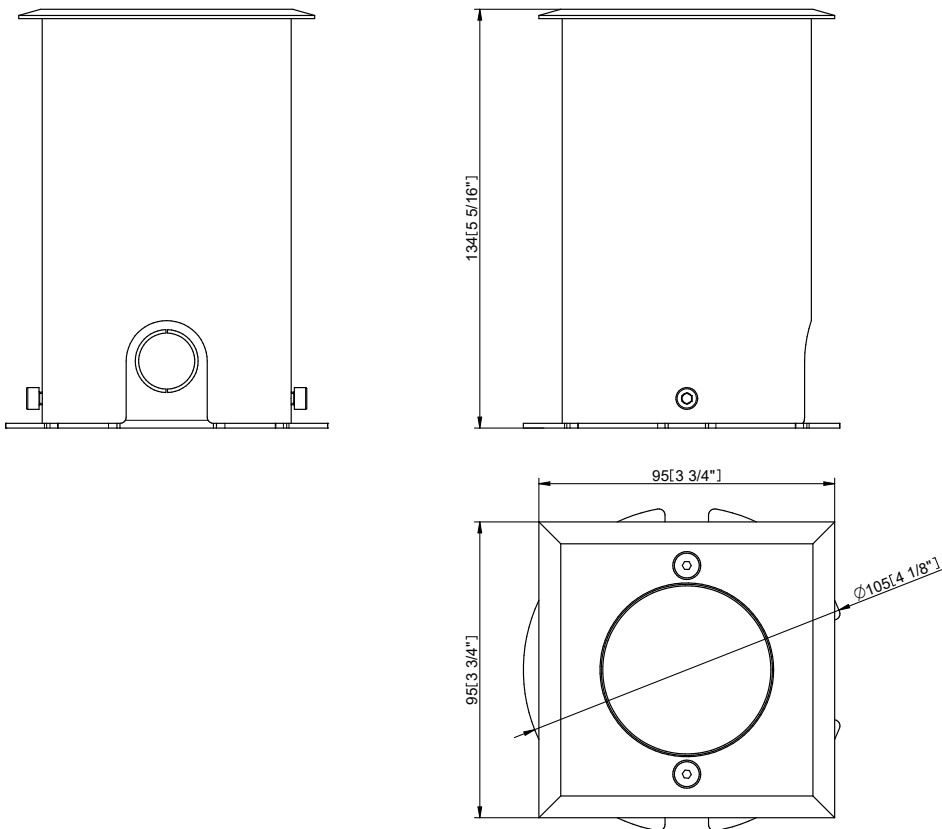

with Round flush Trim

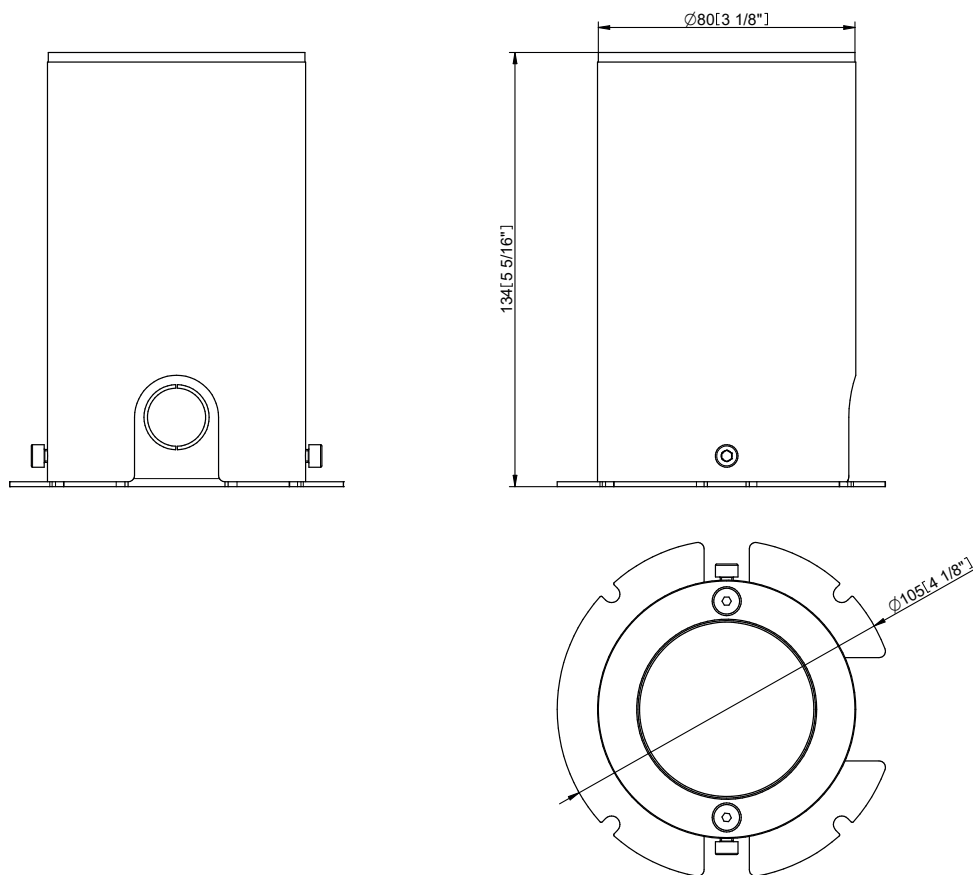

## CONTROL AND CONNECTION OPTIONS

### via E-BOX REMOTE

- 1) SJTW 5x 14AWG (1305 3336), black
- 2) Junction Box Remote (4x Output) + Re-enterable Electrical Insulating Resin (P/N 10980658, sold separately)
- 3) UL 20969 5x 20AWG (13053481), black
- 4) Junction Box Remote (1x Output) + Re-enterable Electrical Insulating Resin (P/N 10980658, sold separately)

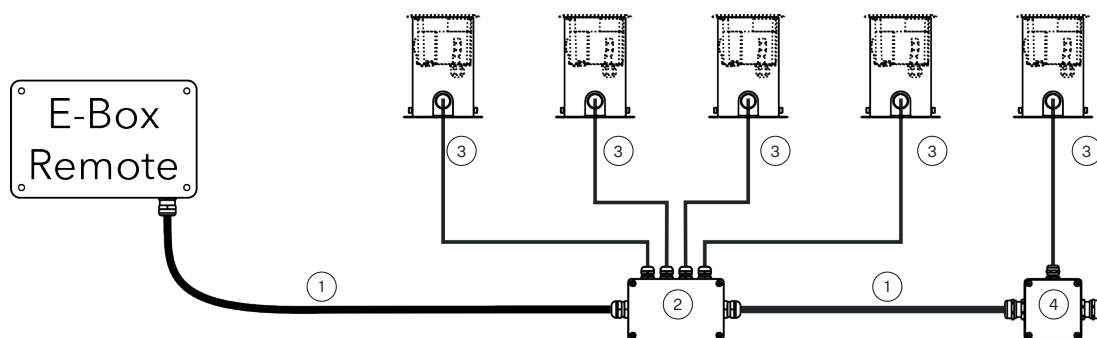

**Note:** All Anolis cables must be in placed in protective conduit – not suitable for direct burial.