

User instructions

ArcSource 1 Shield

The ArcSource 1 Shield generates colored light by means of the high power LED. The product was designed for exterior use and it is ideal for locations where signaling, directional or effect lighting is required.

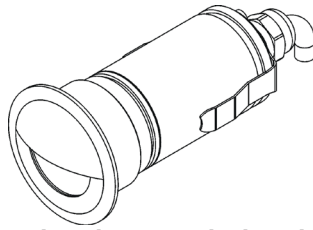

Attention:

Consider the respective national norms during the installation!

Do not install the unit near naked flames

Avoid using the unit in locations subject to possible impacts

Do not attempt to dismantle or modify the unit

The unit is suitable for underwater installation up to depth of 5 m

Technical specifications:

Input voltage:	9-35V DC or 6-24V AC
Maximum power consumption:	1.6 Watts
Built-in ArcSource 1 driver:	Operates on variable AC or DC input, keeps constant current to the LED
Operating ambient temp. range:	-20°C/+40°C -
Cooling system:	conduct. cooling system
LED device:	ProLight Opto 3Watt Proeon
Typical lumen maintenance:	70% @ 50,000 hours
LED life expectancy:	minimum 50,000 hours
Glass cover:	6 mm flat tempered glass (clear)
Beam angles:	9°, 25°,
Light colours:	red, green, amber, blue, cool white, warm white
Construction:	Stainless steel top flange Brass housing
Protection factor:	IP 68
IK rating:	IK 10
Wiring:	1m long Ölflex Robust 210 cable, 2x0.5mm ²
Mounting depth:	90 mm (plus cca 20 mm for cable bend)

Installation:

The ArcSource 1 Shield can be arranged in any position orientation. Spring clips enable to hold the light in prepared positions in concrete, paving or walls. Connect to the end of the ArcSource's cable to the desired AC (DC) power supply.

Dimensions(mm):

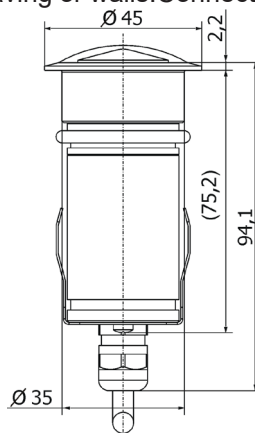

Weight:

0.3 kg

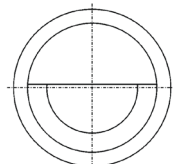

Version 1.1

Specifications are subject to change without notice

.May 2, 2017